

Workrite **Glide™**



### Keyboard Comfort Above and Beyond

Whether you are outfitting one workstation or thousands, Workrite Glide moves to everyone's comfort level. Its limitless range of adjustability is out of this world. Engineered to exacting specifications, critical components are quality tested to be within one half the width of a human hair. This careful attention to detail continues with the selection of unique materials including a jet engine control component that ensures thousands of smooth adjustments for years to come. With 24 standard configurations, Workrite Glide will meet the needs of workers around the clock and around the globe.

**Workrite**  
ergonomics®

# Workrite Glide™ Adjustable Keyboards - Preconfigured Systems

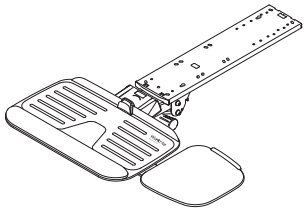

Our most flexible and feature-rich keyboard system, the Workrite Glide™ combines style and ultimate ergonomic benefit. Combined with our Pinnacle 2 Arm the Workrite Glide system provides out-of-this-world comfort.

### Keyboard Platform features:

- Model UC-3100 or UG-3100 platform
- Mouse platform glides on track to accommodate right to left-hand mousing
- Unique mouse platform with Mouse-Over™, Mouse-Forward™, Mouse-Back and In-Line™ positions for maximum flexibility and comfort
- Sliding document holder and cord management
- No-slip keyboard mat and mouse-trap keep your mouse and keyboard in place
- Mouse platform tilts independently from keyboard +/- 20°
- Over 210 square inches of mousing area in Mouse-Over position
- Removable palm support; optional mouse palm support
- Available in charcoal or cool gray
- User instructions printed on mouse pad
- Exceeds ANSI/BIFMA X5.5-2008 durability standard

### Keyboard Arm features:

- Specify Pinnacle 2 Arm with 17" or 22" low profile ball bearing track or Pinnacle 2-Value with 17" or 22" nylon track
- Height range: flush to 6" below the worksurface
- Tilt range: -15° to +10°
- 360° swivel—easy positioning and storage
- No-knob, no-lever Lift-N-Lock
- Maximum knee clearance

### LEED Eligibility

- All Workrite Glide Systems exceed LEED requirement MR4.1 (10% recycled content) and may be eligible for 1 point.
  - Most Workrite Glide Systems exceed LEED requirement MR4.2 (20% recycled content) and may be eligible for up to 2 points.
- Innovation and design, credits 1.1–1.4  
 · Implementation of comprehensive ergonomic program (1-4 points)
- Ultra-Thin platform surface made from GREENGUARD® certified materials

Platform Color	Foam	Track Length	Model #	Weight	LEED %		
<b>Pinnacle 2 Arm</b>							
Charcoal	Without mouse palm support	Jel 22"	<b>3111-22J</b>	18	22		
		Standard 22"	<b>3111-22</b>	18	22		
		Jel 17"	<b>3111-17J</b>	16	21		
	Standard 17"	<b>3111-17</b>	16	21			
		With mouse palm support	Jel 22"	<b>3131-22J</b>	18	22	
			Standard 22"	<b>3131-22</b>	18	22	
Jel 17"	<b>3131-17J</b>		16	21			
Standard 17"	<b>3131-17</b>	16	21				
	Cool Gray	Without mouse palm support	Jel 22"	<b>3112-22J</b>	18	22	
			Standard 22"	<b>3112-22</b>	18	22	
Jel 17"			<b>3112-17J</b>	16	21		
Standard 17"		<b>3112-17</b>	16	21			
		With mouse palm support	Jel 22"	<b>3132-22J</b>	18	22	
			Standard 22"	<b>3132-22</b>	18	22	
Jel 17"	<b>3132-17J</b>		16	21			
Standard 17"	<b>3132-17</b>	16	21				
	<b>Pinnacle 2-Value Arm</b>						
	Charcoal	Without mouse palm support	Jel 22"	<b>3121-22J</b>	17	20	
Standard 22"			<b>3121-22</b>	17	20		
Jel 17"			<b>3121-17J</b>	15	19		
Standard 17"		<b>3121-17</b>	15	19			
		Cool Gray	Without mouse palm support	Jel 22"	<b>3122-22J</b>	17	20
				Standard 22"	<b>3122-22</b>	17	20
Jel 17"	<b>3122-17J</b>			15	19		
Standard 17"	<b>3122-17</b>		15	19			

### Dimensions

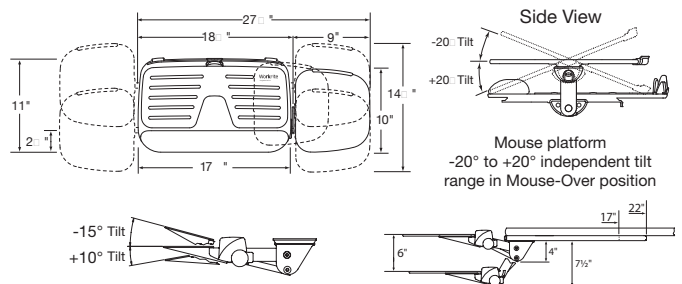

### Mousing Positions

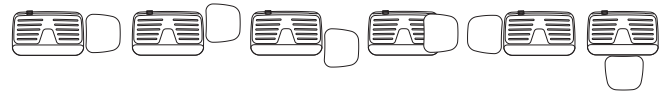

### Desk Compatibility

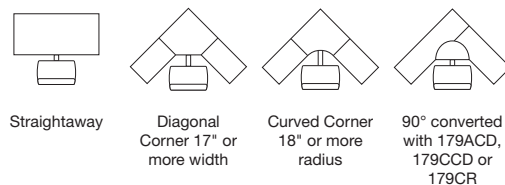

©2010 Workrite Ergonomics  
 All referenced company and product names are trademarks, registered trademarks or copyrights of their respective holders.

1400223-0610 Subject to change without notice.

Workrite Ergonomics, Inc.  
 1450 Technology Lane,  
 Petaluma, CA 94954  
 www.workriteergo.com  
 800.959.9675

**Workrite**  
 ergonomics®